

## Straight Peened Grab Rail

### SMR327P to SMR332P

300MM - 750MM CENTRE TO CENTRE OPTIONS

**SMR327P - 300mm C to C**

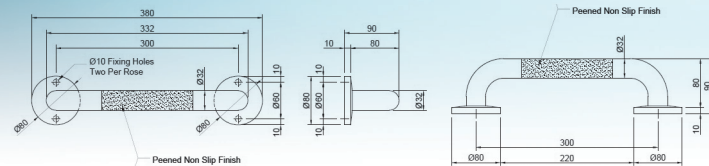

### SPECIFICATIONS

**Material** #304 Stainless Steel - 32mmØ

**Finish** Satin Stainless Steel  
Peened Non Slip Finish

**Mounting** Concealed Fix - 80mmØ Mount

\*This unit is accessible compliant when installed in accordance with NZS 4121:2001-Section 10.



**SMR330P - 450mm C to C**

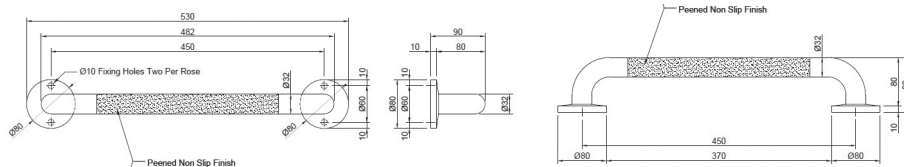

**SMR331P - 600mm C to C**

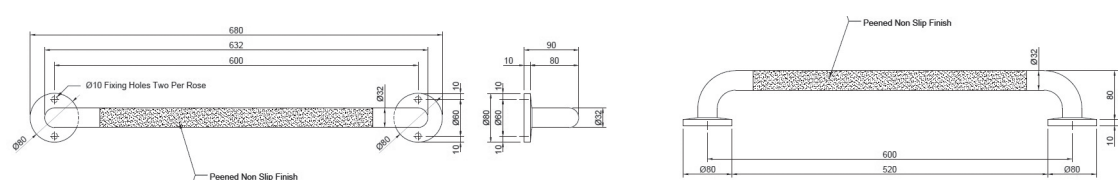

**SMR332P - 750mm C to C**

